

Document 2.4H Plan 8A

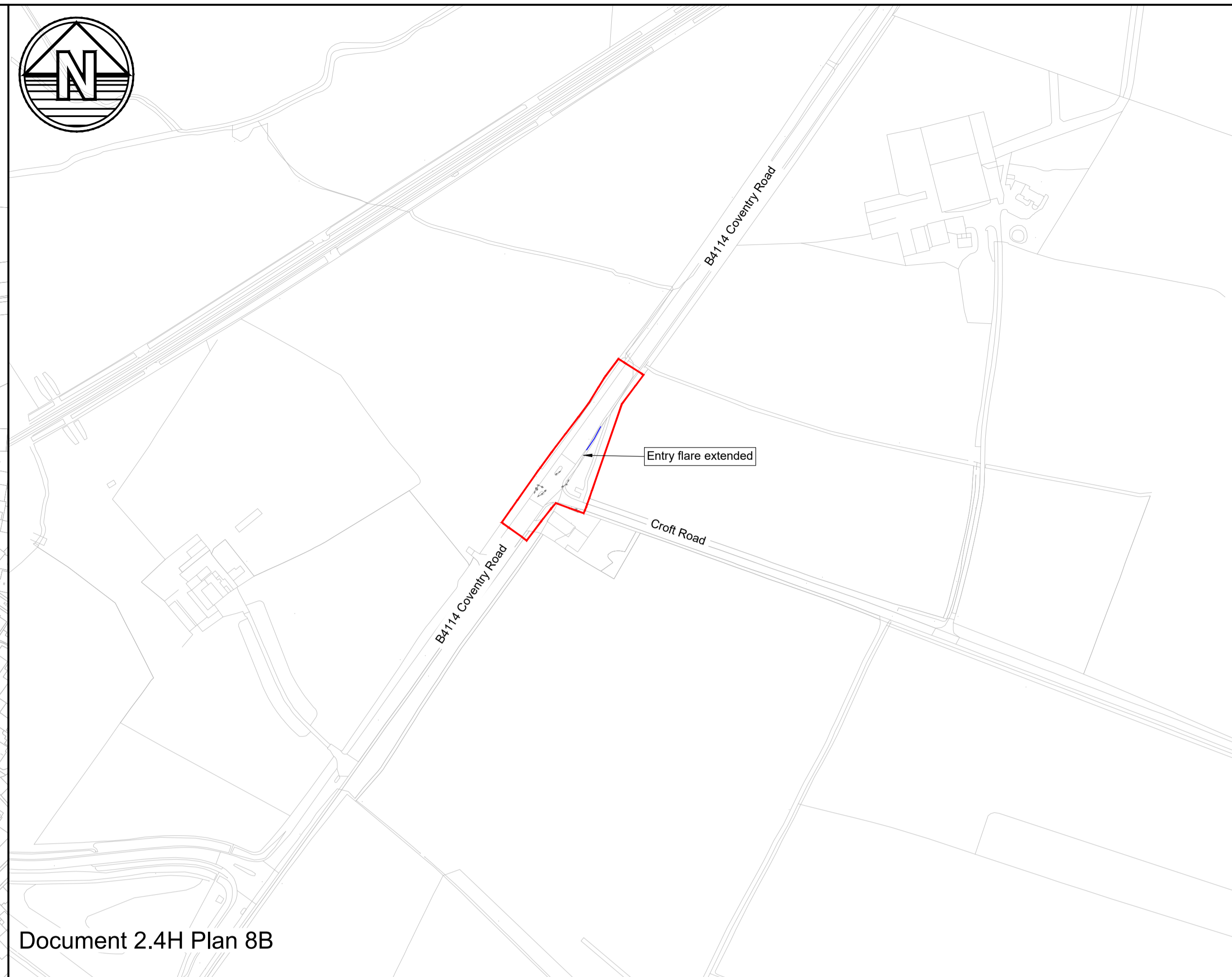

Document 2.4H Plan 8B

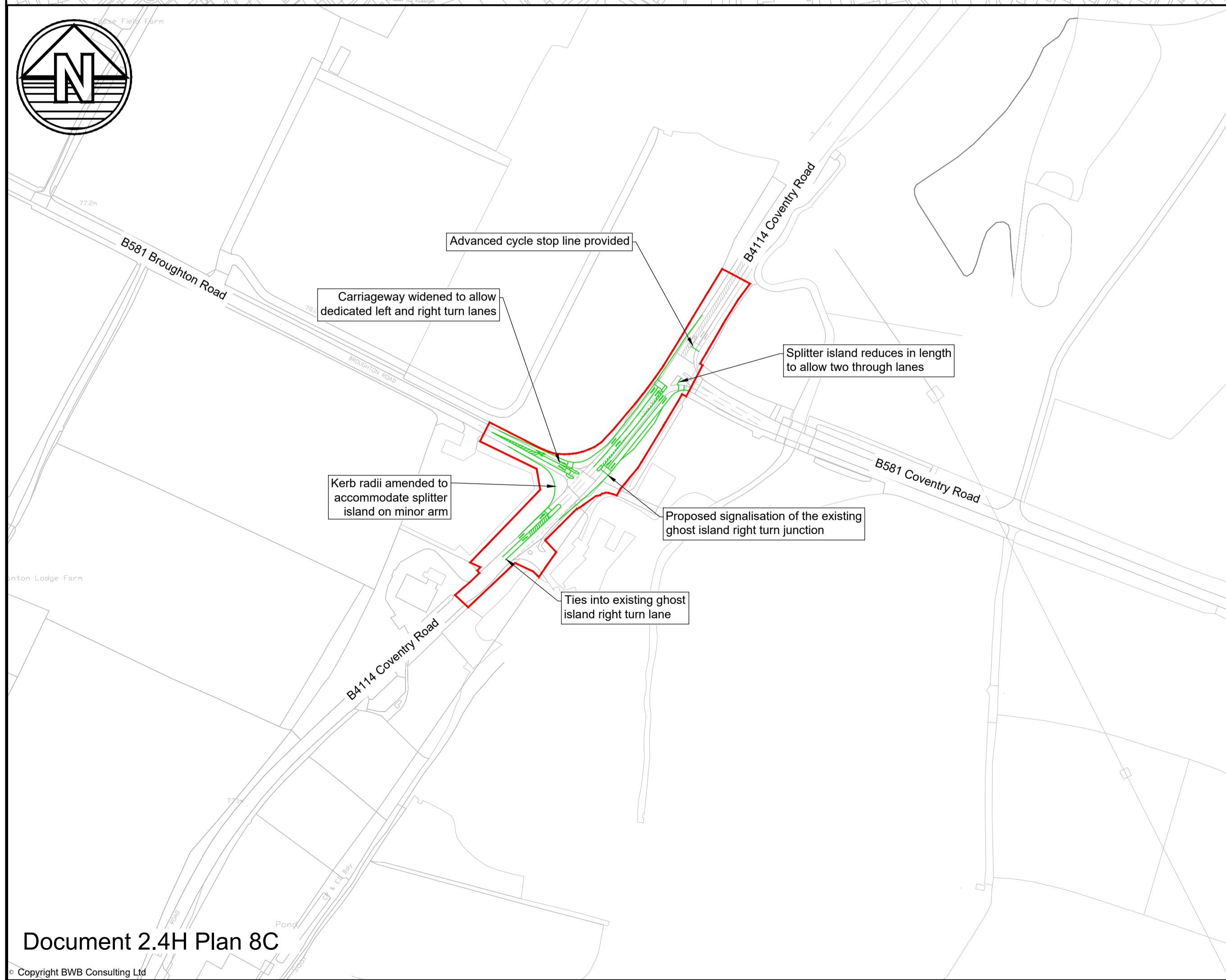

Document 2.4H Plan 8C

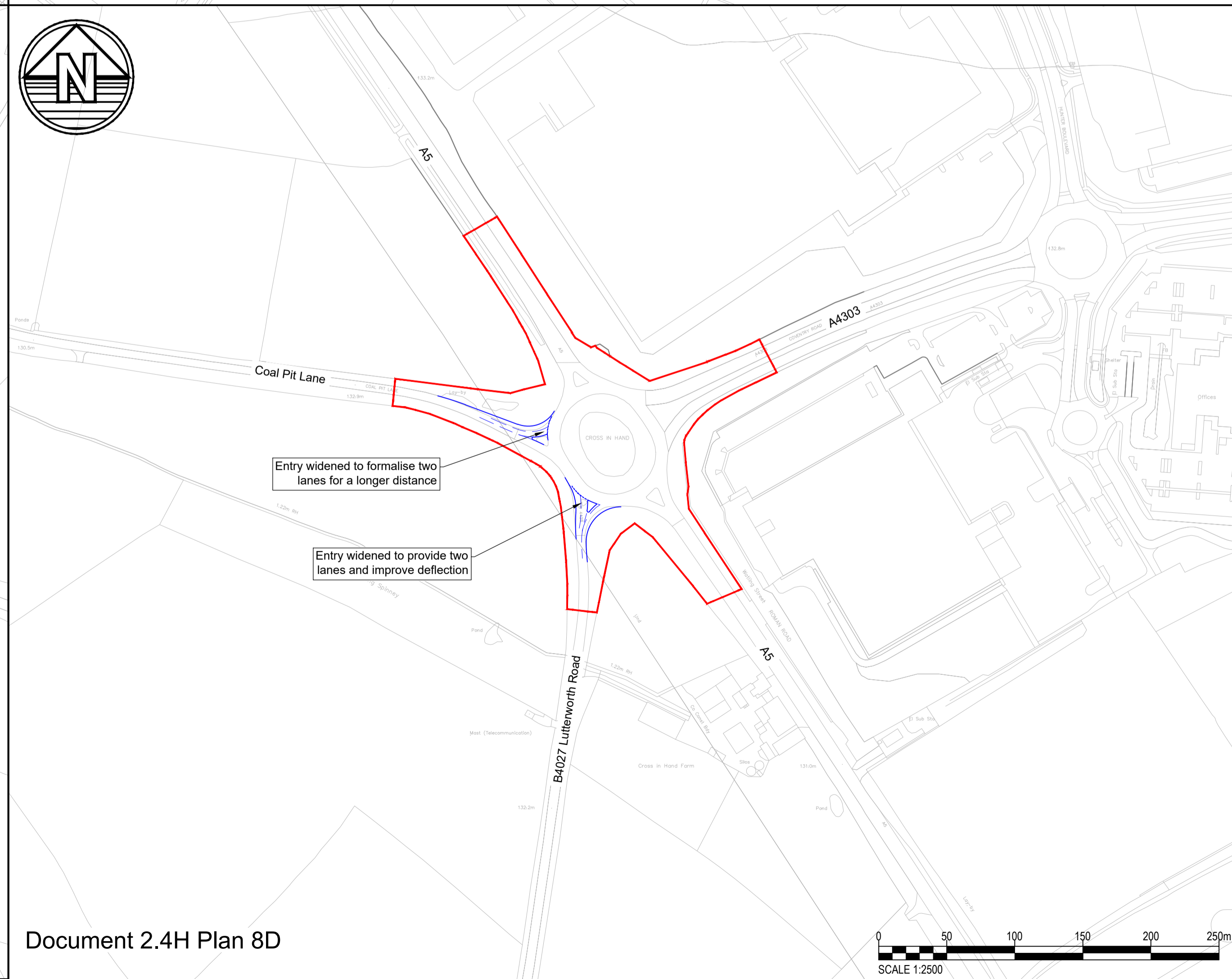

Document 2.4H Plan 8D

**Note**  
 The purpose of the Highway Plans is to illustrate highway mitigation works proposed in relation to the Hinckley National Rail Freight Interchange.

**Legend**

- ORDER LIMITS
- ||||| ALL BLUE MARKINGS DENOTES HIGHWAY WORKS
- ||||| ALL GREEN MARKINGS DENOTES COMMITTED HIGHWAY WORKS BY OTHERS

THE UNDERTAKER SHALL NOT BE OBLIGED TO UNDERTAKE HIGHWAY WORKS COMMITTED BY OTHERS IF A THIRD PARTY HAS COMMENCED CONSTRUCTION OF THESE WORKS PRIOR TO THE RELEVANT STAGE OF DEVELOPMENT SET OUT UNDER SCHEDULE 2 PART 1 OF THE DEVELOPMENT CONSENT ORDER

- ACOUSTIC FENCE - FOR DETAILS REFER TO ENVIRONMENTAL STATEMENT - NOISE & VIBRATION: CHAPTER 10 REF 6.1.10

THE LEGEND IS IDENTICAL ON ALL SHEETS OF THE HIGHWAY PLANS AND THEREFORE NOT ALL ITEMS DETAILED IN THE LEGEND ARE REPRESENTED ON EACH SHEET

P06	09.02.24	Cross in Hand Mitigation Updated	JM	SC
P05	04.01.24	Updated to reflect discussions with LHA	JM	SC
P04	04.09.23	Magna Park & Coventry Rd junctions updated	DF	SC
P03	04.01.23	Legend amended	DF	SC
P02	30.11.22	Final Issue	DF	SC
P01	16.12.21	Issue for Consultation	DF	SC
Rev	Date	Details of issue / revision	Drw	Chd

**Issues & Revisions**

Client



A TRITAX BIG BOX COMPANY

Project Title  
**HINCKLEY NATIONAL RAIL FREIGHT INTERCHANGE**

Drawing Title  
**HIGHWAY PLANS SHEET 8 OF 8**

Regulation:	<b>5(2) (o)</b>	Document:	<b>2.4H</b>
Drawn:	D. Fraser	Checked:	S. Carter
BWB Ref:	NTT 2814	Date:	17.12.21
Project - Originator - Functional Breakdown - Spatial Breakdown - Form - Discipline - Number			
<b>HRF-BWB-LSI-D8-DR-CH-00100</b>			
Drawing Status	<b>S4 - FINAL</b>		Rev
			<b>P06</b>

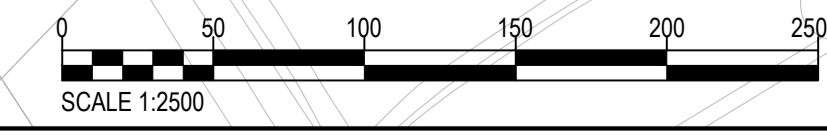

Copyright BWB Consulting Ltd  
 X:\NTT\NTT2814\_Hinckley Rail Freight Interchange\02\_Project Delivery\01\_WIP\Drawings\Other drawings\HRF-BWB-LSI-D8-DR-CH-00100\_Highway Plans.dwg